

GRIFform INNOVATIONS®

Wall Cladding

Wall Panels

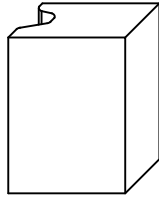

Grooved End

Standard Wall Panels			
30" to 44" High			
Typical 96" long			
¼" Thickness			
WP30	30" x 96"	WP41	41" x 96"
WP38	38" x 96"	WP42	42" x 96"
WP40	40" x 96"	WP43	43" x 96"
		WP44	44" x 96"

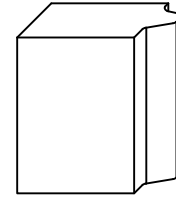

Tongue End

The final wall cladding height is a combination of the panel height plus the combined heights of the Top Rail and Baseboard minus the overlap.

Example: Baseboard Height + Wall Panel Height + Rail Height - ¾" Panel Overlap - ¾" Panel Overlap = Final Wall Cladding Height

Note: This is allowing for ¼" expansion spacers. (see Example A below)

Ends of the panels can be tongue and grooved for end to end field seams to make panels to 24 feet long before a mullion (expansion joint) is recommended.

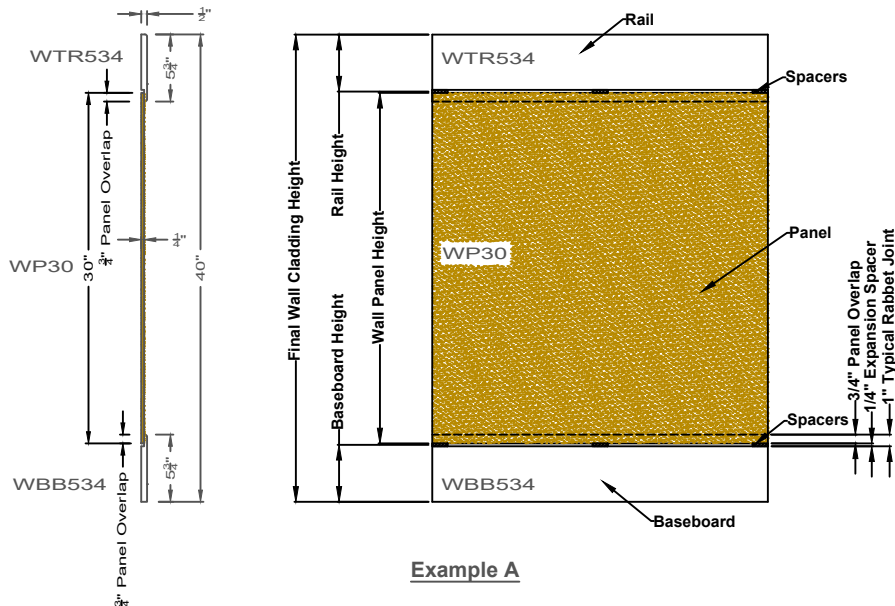

Example A

Example A: Baseboard Height + Wall Panel Height + Rail Height - ¾" Panel Overlap - ¾" Panel Overlap = Final Wall Cladding Height

Note: This is allowing for ¼" expansion spacers. (see Example A below)

$$\begin{aligned} \text{WBB534} + \text{WP30} + \text{WTR534} - \frac{3}{4}'' \text{ Panel Overlap} - \frac{3}{4}'' \text{ Panel Overlap} &= \text{Final Wall Cladding Height} \\ 5 \frac{3}{4}'' + 30'' + 5 \frac{3}{4}'' - \frac{3}{4}'' - \frac{3}{4}'' &= \text{Final Wall Cladding Height} \\ 40'' &= \text{Final Wall Cladding Height} \end{aligned}$$